

Casing Heads

SW-22 casing heads feature a straight bore design that is compatible with slip and mandrel type casing hangers.

Features

- Features a 45° landing shoulder capable of supporting maximum loads
- Prevents test plugs from wedging under pressure

Outlets

- Line Pipe Outlets
- Studded Side Outlets

Casing Hanger Compatibility

- SW-21 and SW-22 slip-type casing hangers
- Mandrel style casing hangers

Manufacturing Standard

- API-6A

Availability

- Additional sizes available upon request
- Available in SW-29 profile upon request

Lock screws

- SW-22-BP casing heads are supplied with (2) lockscrews for wear bushing retention
- SW-22-L and SW-29-L casing head are supplied with a full set of lockscrews for mandrel casing hanger and packoff retention

Bottom Connections

- Slip-on weld
- Slip-on weld with o-ring
- Threaded

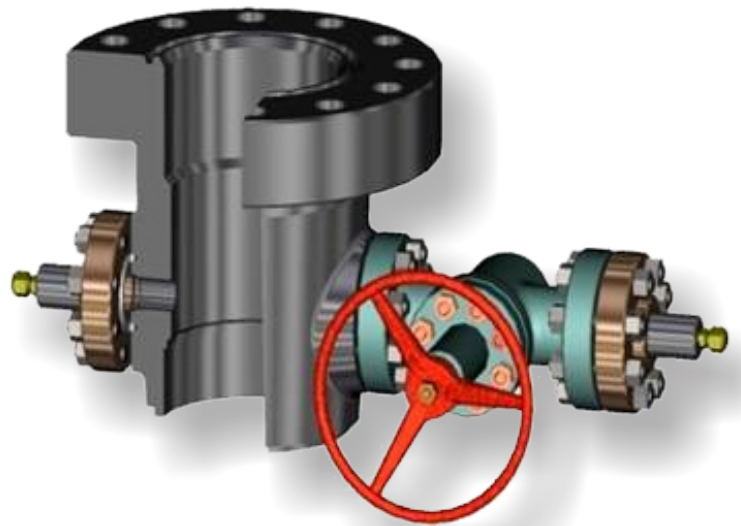

Casing Heads

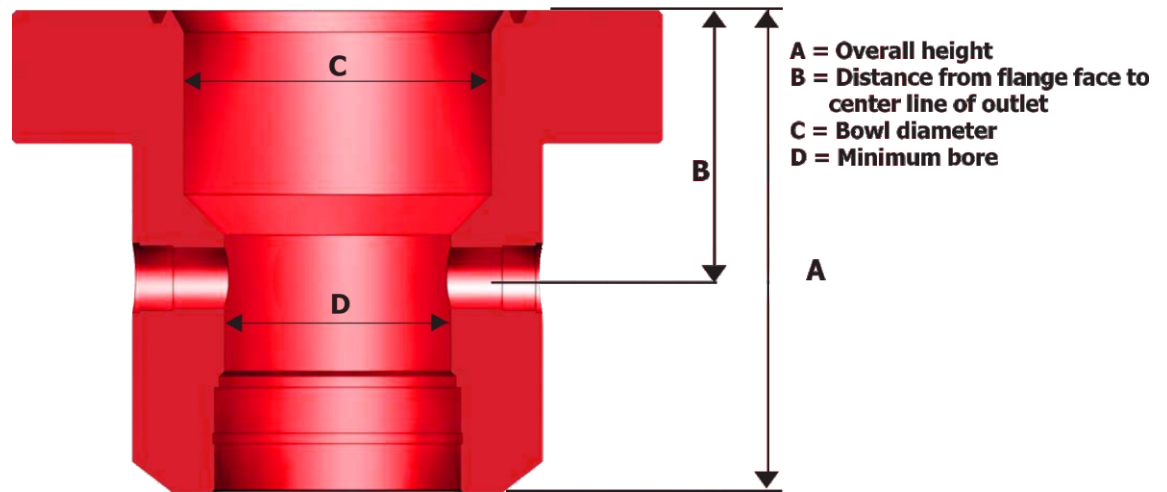

Specifications

| Flange Size | Working Pressure | Casing Size | A | B | C | D | Part Number |
|-------------|------------------|-------------|-----|---------|---------|---------|-------------|
| 11" | 2,000 | 9-5/8" | 17" | 10-1/8" | 10-7/8" | 9" | |
| 11" | 3,000 | 8-5/8" | 17" | 10-1/8" | 10-7/8" | 8" | |
| 11" | 3,000 | 9-5/8" | 17" | 10-1/8" | 10-7/8" | 9" | |
| 11" | 3,000 | 10-3/4" | 17" | 10-1/8" | 10-7/8" | 10" | |
| 11" | 5,000 | 8-5/8" | 17" | 10-1/2" | 10-7/8" | 8" | |
| 11" | 5,000 | 9-5/8" | 17" | 10-1/2" | 10-7/8" | 9" | |
| 11" | 5,000 | 10-3/4" | 17" | 10-1/2" | 10-7/8" | 10" | |
| 13-5/8" | 3,000 | 13-3/8" | 17" | 10-1/4" | 13-1/2" | 12-1/2" | |
| 13-5/8" | 5,000 | 13-3/8" | 19" | 10-1/4" | 13-1/2" | 12-3/8" | |
| 21-1/4" | 2,000 | 20" | 20" | 10-1/4" | 21-1/8" | 19" | |
| 20-3/4" | 3,000 | 20" | 23" | 15" | 20-1/8" | 19" | |